

Typenex Medical

Original Blood Band
Training Guide

Step 1

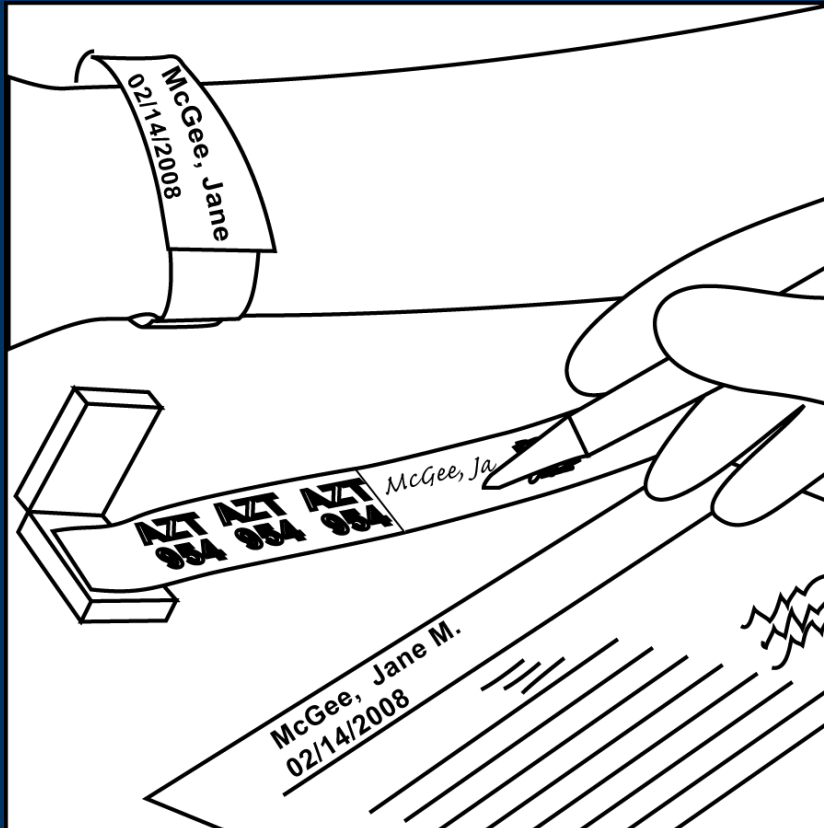

- Verify the patient's identity
- Using a ballpoint pen, fill in the ID label, so the patient information is legible

Step 2

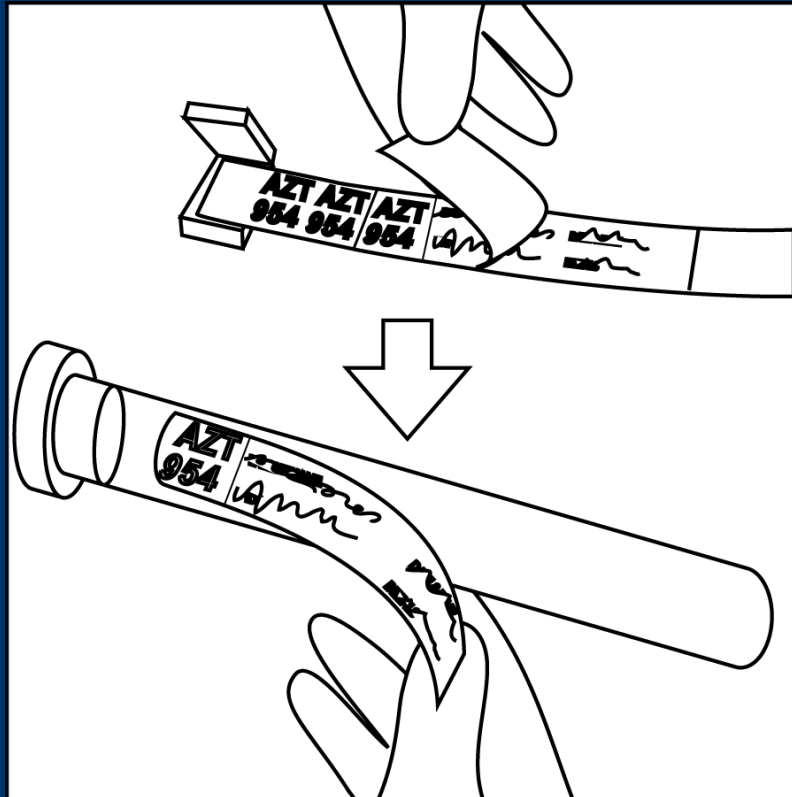

- Peel the completed ID label from the band
- Affix it lengthwise along the patient's sample tube with the number near the top
- A carbon copy of the ID label will remain on the band and darken over time

Step 3

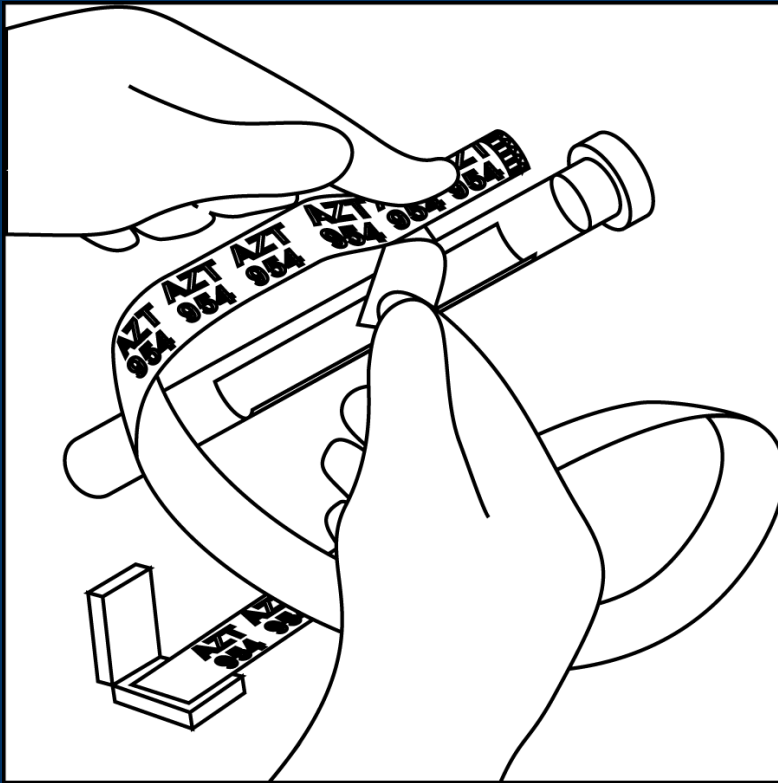

- Remove the backing from the tail-end of the band
- Affix the exposed adhesive strip lengthwise to the patient's sample tube
- Take care not to cover any part of the ID label

Step 4

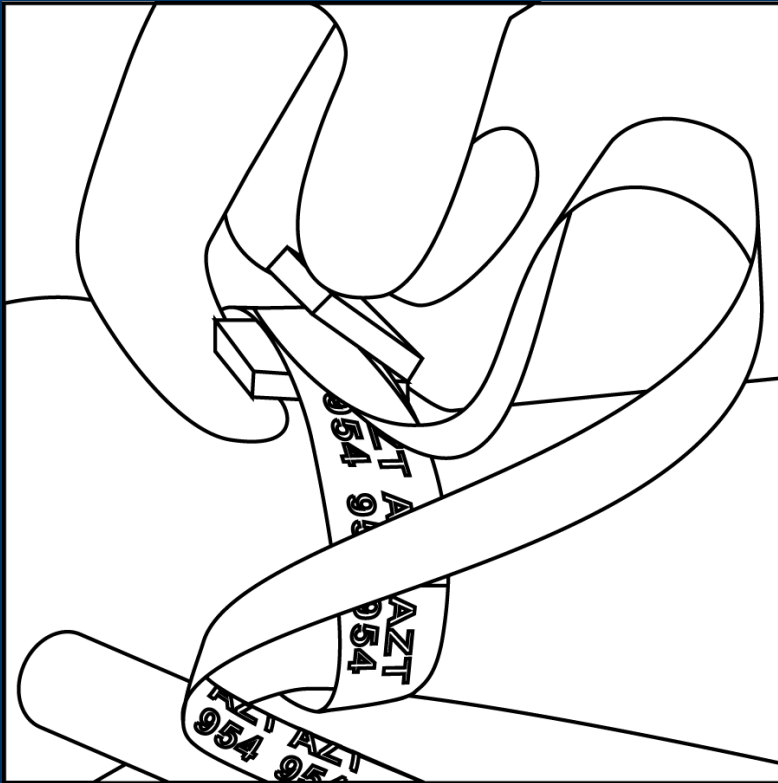

- With the patient's sample tube still attached, grasp the clip with text facing you
- Wrap the band once around patient's extremity
- Center the band between the clip posts and snap firmly

Step 5

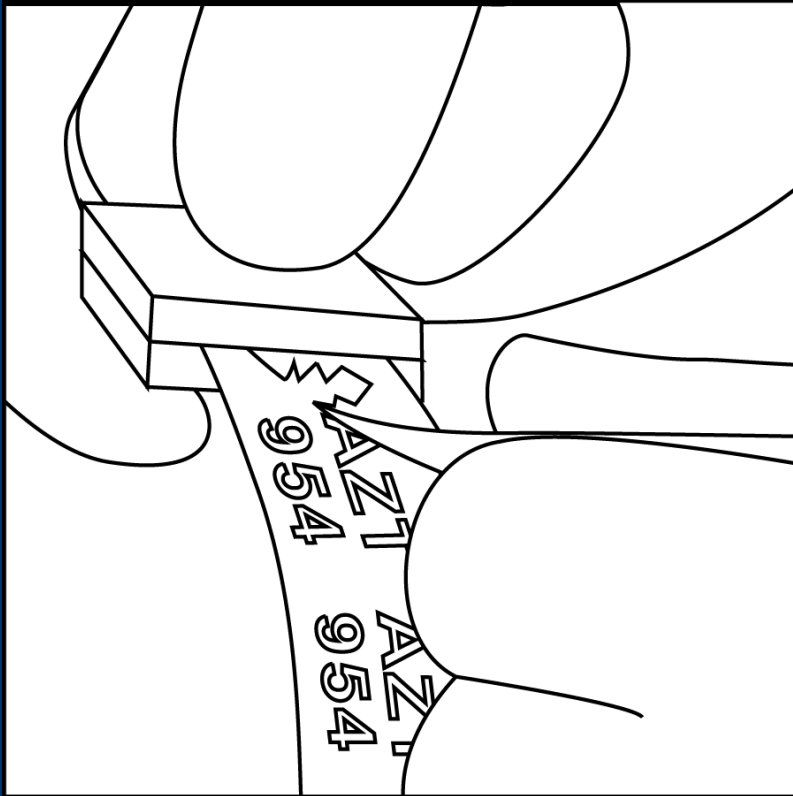

- Once closed, the clip will cut the band
- Detach the tail and patient's sample tube by holding the clip firmly while tearing down and away from patient with a twisting motion
- Using the patient's sample tube, draw the blood

Step 6

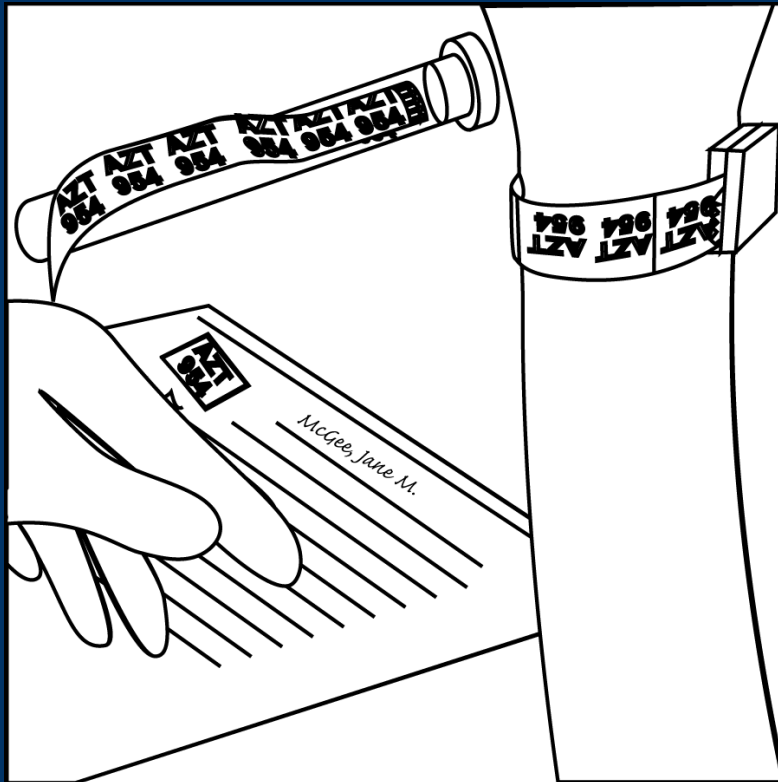

- Peel a coded sticker from the tail
- Ensure that the information on the blood sample, patient band and request form are identical
- Transfer patient sample to blood bank

Step 7

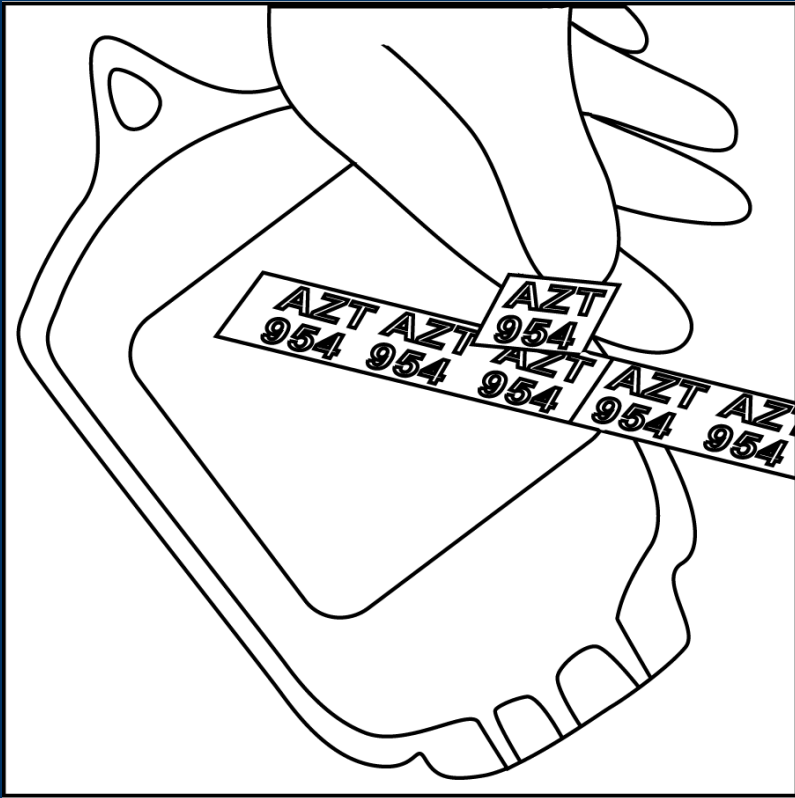

- At the time of crossmatch, remove a coded sticker from the sample tube and attach to a corresponding unit of blood

Step 8

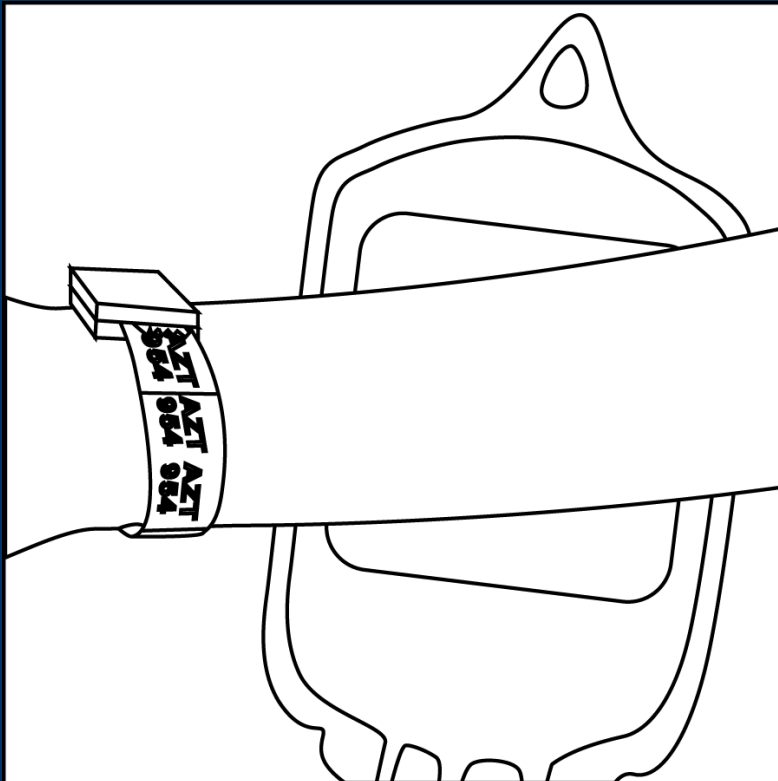

- Verify the patient identity, confirm all identifying information
- Check that the Typenex band is intact
- Confirm that the patient BBID and coded sticker on each unit of blood are a positive match before beginning transfusion
- Proceed with transfusion